

1407-4

Patricia Kimle creates a polymer clay cabochon with fine silver.

Watch the video for this project online at:
<http://youtu.be/NbluRGQWup8>

Bezel pendant with faux granite

Materials needed

15 grams metal clay
Metal clay paste slip
Easy paste solder
2" length 1x3mm sterling flat wire
Sculpey Superflex Bake and Bend Polymer clay
Premo Accents Granite clay
Liver of Sulfur or Black Max (optional)

Tools

Various tools to draw patterns in clay (ball stylus, plastic cards, needle tools, straws, etc.)
Hand balm or olive oil
Craft knife
Bamboo skewer or nail stick about ¼" diameter
Metal clay sanding pad
Fine metal file
Soldering tools—ceramic fiber board, torch, tweezers
Pickle solution (1 T citric acid powder and 1 cup warm water)
Wet/dry sandpaper, 320 grit, 400 grit and 600 grit
Jeweler's lathe with a muslin buffing wheel or water-based varnish (optional)
Super glue

Instructions

1. Condition and roll out about ½ package of Bake and Bend clay into 2 sheets about 2 mm thick. Draw patterns with tools into the surface, creating two complimentary patterns for the front and back of the pendant.
2. Roll the metal clay to about 4 cards (2mm thick). Oil both molds and sandwich the clay between them. Roll firmly across the stack and carefully peel them apart.
3. Cut a pattern for the shape and place it on the textured clay. Cut around the shape, leaving about a 1" extended tab at the top for the rolled bail.
4. Roll the bail around a skewer or nail stick. With a small paintbrush, apply a thick layer of paste slip at the point where the bail connects to the base shape. Dry completely.
5. Refine the edges and the texture with a fine sanding pad.
6. File the cut edges of the wire smooth and square. Bend the flat wire into an oval and apply a dab of paste solder to the joint. Heat with a torch until the solder flows. With round and right angle forming pliers,

refine the shape of the bezel to complement the pendant shape.

7. Apply paste solder all around the inside edge of the bezel and position it on the pendant. Heat with the torch until the solder flows. Place the pendant in a warm pickle solution until clean.
8. If desired, oxidize the pendant in a Liver of Sulfur solution or with Black Max and polish the piece again. Roll a small ball of clay and press it into the bezel, rounding the top surface.
9. Remove the clay and sand and buff or varnish the surface. Replace the clay with a drop of super glue.

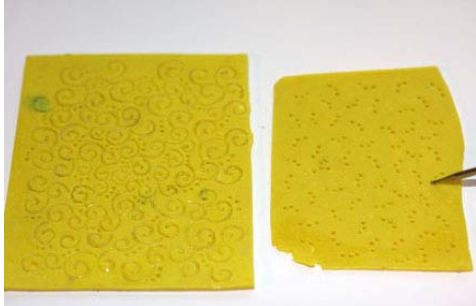

Step 1



Step 2



Step 3



Step 4

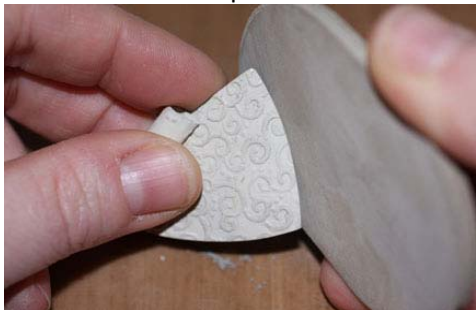

Step 5



Step 6



Step 7



Step 8



Final Project

Guest:



Marlene Blessing