

# Viking Knit Freeform Floral

Design by Stephanie J Eddy ©2013

## MATERIALS

- 25 feet of 26 gauge green wire
- 16 inches of 18 gauge green wire
- 3 g 11° dark green seed beads (A)
- 3 g 11° gold seed beads (B)
- 3 g 11° light green seed beads (C)
- 3 g 11° pink seed beads (D)
- 3 g 8° olive seed beads (#8)
- 1 12mm fire polished bead
- 6 4mm fire polished beads
- 1 4mm daisy spacer
- 2 9x9mm (1/4") end caps
- 1 lapel pin or small barrette

## TOOLS

- 1/4-inch Lazee Daizee™ tool
- Miniature funnel
- Wire cutter, round nose pliers and draw plate with 1/4" hole



Floral Pin or Hair Adornment

**Basic instructions for using the Lazee Daizee™ Viking Knit tool are include with the tool.**

**There is also an instructional reference video available at [www.stephanieeddy.com](http://www.stephanieeddy.com)**

**Start:** With 26 gauge wire, begin a single 6-loop Viking Knit weave to form the floral stem. Complete 3-4 inches.

**Step 1:** To create the flower, add a new 48-inch length of the 26 gauge wire to the weave. It is best to create the flower with a single length of wire instead of splicing more wire into the weave. Work four rows of single weave, splicing in the tails as you go. Trim the tails to 1/4-inch.

*Continue the basic Viking Knit weave adding beads on each rung.*

**Petal Row 1:** Add two A beads on each rung around the row.

**Petal Row 2:** Add one A bead, one #8 bead and one A bead on each rung around the row. Allow longer loops and rungs to accommodate the width of the beads.

Remove the weave from the Lazee Daizee™ tool and slide it onto a miniature plastic funnel.

**Petal Row 3:** Add beads A, B, C, B, A to each rung around the row.

**Petal Row 4:** Add beads A, B, C, 4mm, C, B, A on each rung around the row.

**Petal Row 5:** Add beads A, #8, five D's, #8, A onto each rung around the row.

**Petal Row 6:** Add 12 D beads onto the next rung. Reinforce the loop by going under it a second time. Add 12 D beads onto the rungs in the remainder of the row, reinforcing each loop. Cut the wire.

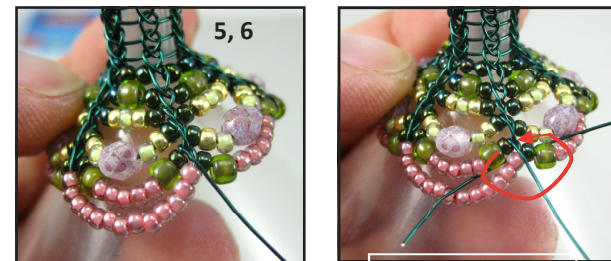
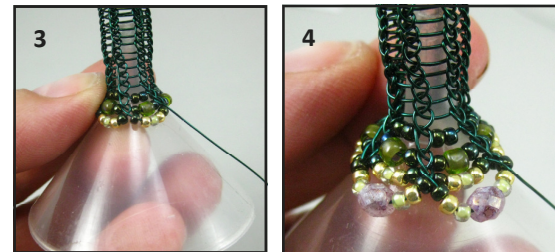
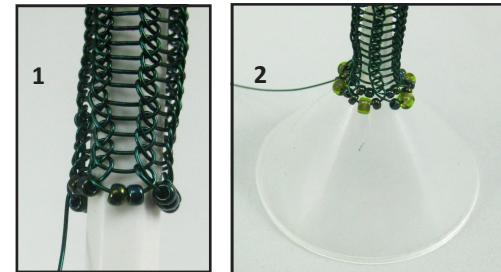
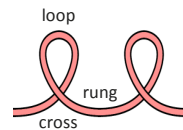

Reinforce the loop

**Step 2:** Remove the Daizee head. Refer to basic instructions. Add draw handles to the raw end of the weave and prepare the weave using the conditioning fabric. Use a draw plate to reduce to 1/4-inch diameter. Reduce the floral stem only—Stop the draw just before the beaded floral weave begins.



**Step 3:** Remove the draw handles and trim the end.

**Step 4:** With 18 gauge wire make a simple loop at one end. Add a spacer, a 12mm bead and an end cap. Insert the wire through the floral end of the weave. Add another end cap and make a simple loop.

**Step 5:** Shape as desired or spiral around a pencil or similar object. Weave a short length of the 26 gauge wire into the base weave to attach a lapel pin or barrette. Bury the wire in the weave and trim.

